

Eliminating Plastic Taste on Start Up

As with most new appliances such as coffee makers and kettles, we strongly recommend cleaning and flushing the reservoir prior to first time use. By following these few small steps you, will help eliminate the common “plastic taste” associated with new appliances assuring great tasting water.

Simply follow these 3 quick and easy steps:

1. Saturate a clean cloth with vinegar. Wipe down inside of reservoir as illustrated.
2. With tap water, fill reservoir 3/4 ways full. Turn switches ON (located at the back of the unit). Let stand 12 hours.
3. After 12 hours, turn switches OFF then drain reservoir via dispensing buttons. Once completely drained, place water bottle on dispenser. You are now ready to dispense great tasting water.

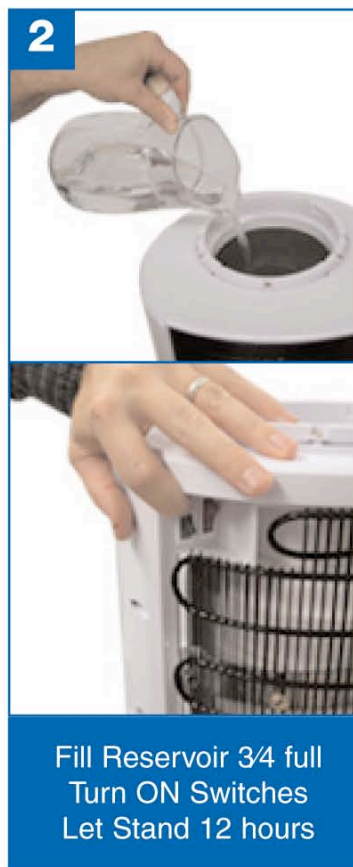
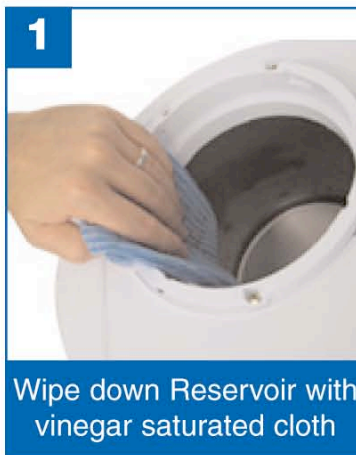

Add Water & Enjoy!

Remember to turn your switches back ON